

# ideas + inspiration

before & after • style matters • small spaces • quick study • design on a budget • smart moves



## Inherent Beauty

Guided by the elegant architecture of a historic mansion, a homeowner gives her master suite the sumptuous bath it deserves.

WRITTEN BY DEBRA WITTRUP PHOTOGRAPHED BY SUSAN GILMORE PRODUCED BY ALECIA STEVENS

### PROBLEM

The master bath of a Victorian Era mansion in St. Paul was dark, cramped, and spartan. "It was pitiful," homeowner Nancy Nicholson says. "It was a single hallway with a bathtub, shower, sink, and toilet at the end. There was hardly any turnaround room."

### SOLUTION

Nancy brought in designer David Heide to give the space an update that's sensitive to the home's original architecture and provides the scale she wanted. To open up the floor plan, Heide appropriated space from adjacent bedroom closets to create a U-shape layout for the fixtures. An art-glass window adds light and interest to the otherwise uninterrupted wall between the bath and bedroom. Generous use of mirrors—above the sinks, over the tub, and facing the hallway—increases the perceived space and reflects light through the room.

### PROBLEM

Nancy wanted to keep the original Crane & Ordway toilet and tub—her relatives once owned the company—but the add-on shower had to go.

### SOLUTION

A marble-encased shower now occupies former closet space. A deep bench and storage niche cater to comfort and efficiency, while a crystal knob on the glass shower door adds a vintage touch. The tub is now a haven dedicated to relaxing baths within a barrel-vault niche.



### Floor Plan

While the tub and toilet remained in their original spots, the floor plan expanded by snagging square footage from two closets. Designer David Heide was able to insert a sumptuous shower, dual sinks, and recessed cabinets into the room. New windows and a profusion of mirrors bounce around natural light, infusing the formerly tight, tunnellike bath with brilliance and warmth.

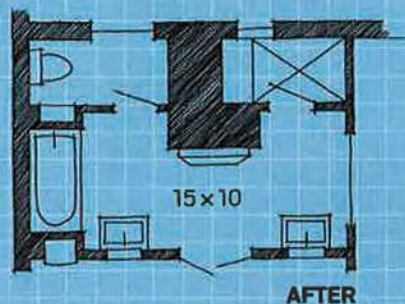

## PROBLEM

The dated and lackluster fittings and furnishings didn't match the grandeur of the home. An old vanity cabinet consumed limited floor space.

## SOLUTION

The vanity was banished in favor of two pedestal sinks flanking the double doors to the room. Mirror-front recessed wall cabinets repeat the arch theme above each sink. Additional elements such as the antique and custom lighting and nickel fixtures infuse the room with vintage flavor. Linoleum flooring was replaced with polished marble in an intricate basket-weave pattern. On the walls, white subway tile gave way to richly veined carrara marble and sunny yellow paint, which enhances the bath's open, bright look.

**OPPOSITE BOTTOM:** A cupboard and open shelving in the water closet create a storage nook that replaces one lost during the renovation. **OPPOSITE TOP:** Repeating motifs and materials, such as arches and leaded glass, found in other parts of the home gives the new bathroom a stately aura of age while providing the luxury homeowner Nancy Nicholson craved. **BELOW:** The tub is original to the home, but it's now enclosed in an arched niche that creates spa-like comfort and richness. **RIGHT:** A separate shower was high on Nancy's wish list for the bath remodel. Enclosed in marble and glass, the spacious new shower is as elegant as it is relaxing.



## PROBLEM

A lack of architectural detail gave the space a utilitarian feel out of character with the historic home designed by architect Cass Gilbert. "You have to be thoughtful when you work on a house with a pedigree like this," Heide says.

## SOLUTION

Taking his cues from other rooms in the house, Heide introduced substantial white baseboards and window and door moldings. The arched millwork over the tub and the window are the same size and proportion as several that Gilbert built into the original structure. Acting as bookends to the space, the arches provide symmetry and add a fluid grace to angular elements in the room. The windows feature leaded glass replicated from other parts of the home.

RESOURCES ON PAGE 114